



S401 DIG/N

DIGITAL pH ELECTRODE WITH TEMPERATURE



S401 DIG/N pH and Temperature Digital Electrode

The sensor **S401 DIG/N** is used for measurement of pH in pure water, wastewater treatment plants, suspended solids processes, processes with pollutants, galvanic processes.

Applications

pH Measurement in:

- Water and Wastewater Treatment
- Process Monitoring and Control

Features and benefits

- Reliable pH measure thanks to the use of a digital measurement
- Communication of measurements via MODBUS RTU protocol
- Suitable for many industrial applications
- Easy to connect to the process
- Integrated temperature sensor
- 11bar operating Pressure
- 100°C Operating Temperature

The S401 DIG/N pH Electrode is suitable for pH measures in various applications. The porous Teflon® septum resists fouling and chemical attack. The new capillary temperature sensor design places the NTC behind the pH-sensitive membrane for accurate temperature compensation and measurement.

Composition of the supply

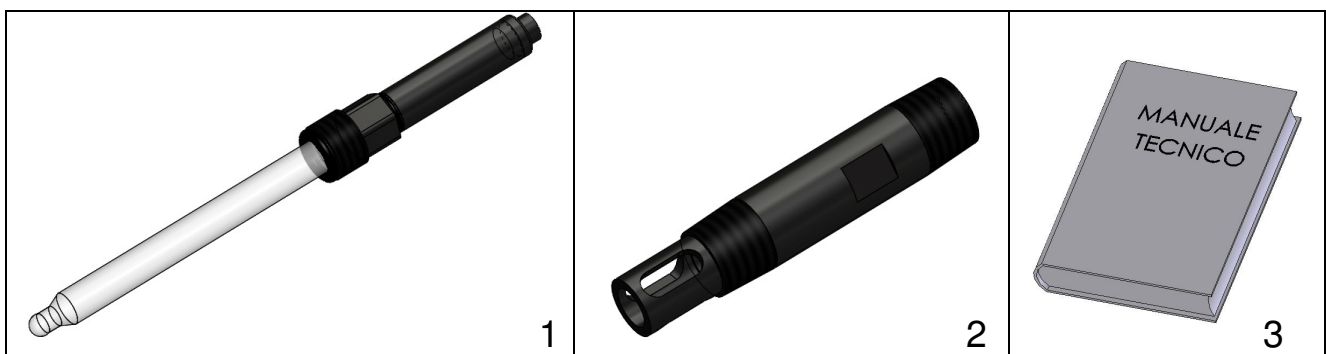

The supply consists of a single package containing the following parts:

1. 1 S401 DIG/N pH Electrode with 10m cable
2. 1 PPS Probeholder
3. 1 Technical manual for instruction

Assembly instructions

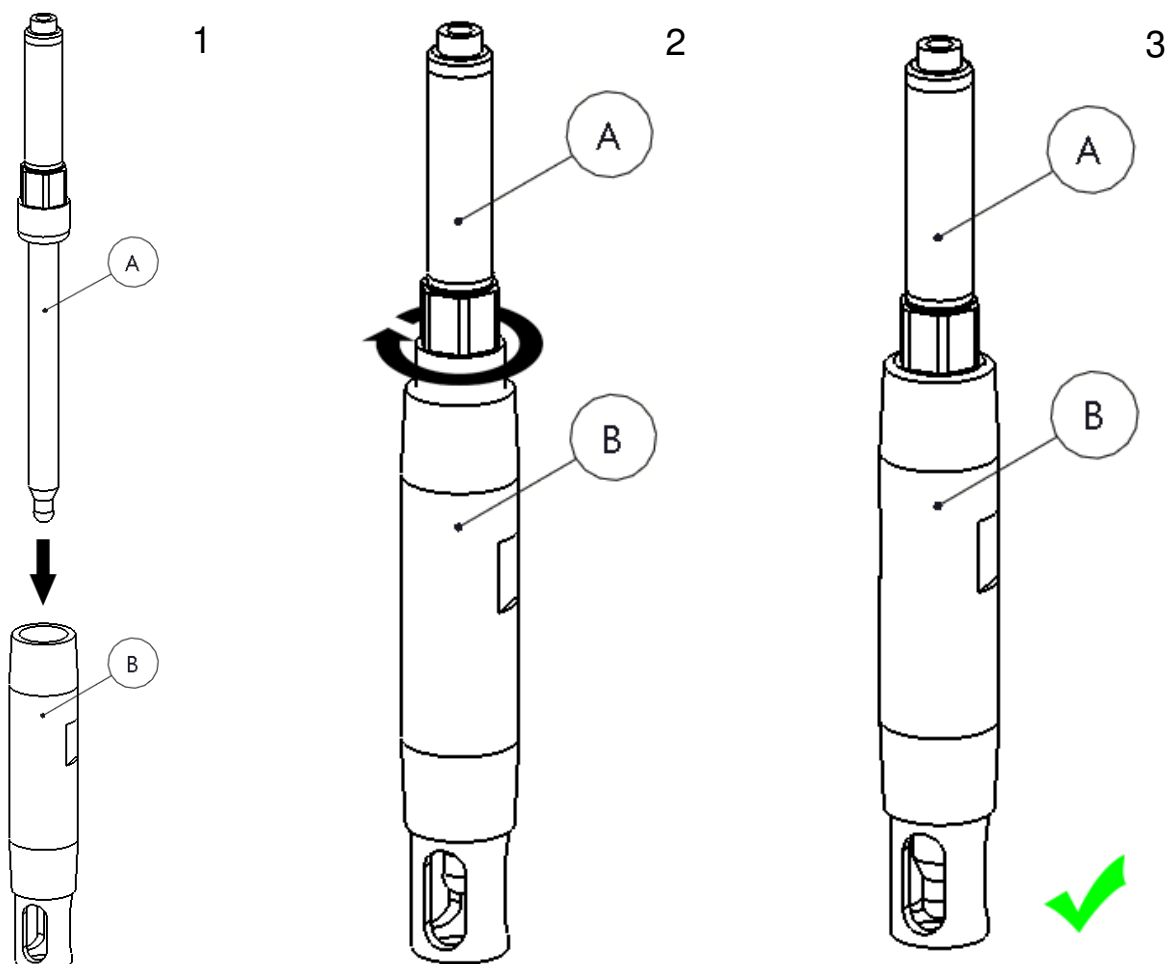

1– Gently insert the electrode A inside the Probe-holder B

2 - Screw the electrode A to the probeholder B taking care NOT TO USE TOOLS such as wrenches, spanners, etc., but only the hands, to avoid a possible glass breakage

3 - The system is ready to be inserted into the process!

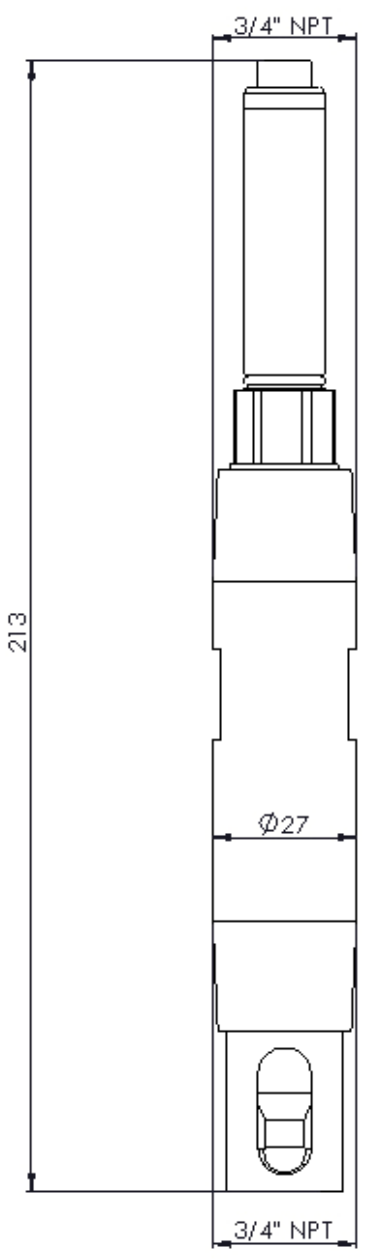
| TECHNICAL DATA | DIMENSIONS |
|---|--|
| Materials : — Glass electrode and PPS bodies — PPS probeholder — Viton® O-Rings — Electrode Diaphragm: Teflon® |  <p>Technical drawing of the pH electrode showing dimensions: 3/4" NPT at the top and bottom, a diameter of $\Phi 27$ mm, and a total height of 213 mm.</p> |
| Electrolyte: Electrolyte Gel | |
| Thread: 3/4" NPT on both sides | |
| Measuring range: 0-14 pH | |
| Measuring method: Digital | |
| Resolution: 0,01 pH | |
| Accuracy: ± 0.05 pH | |
| Repeatability: ± 0.05 pH | |
| Responding time: pH 4..7<30s | |
| Temperature sensor: NTC 30K | |
| Temperature Resolution: 0.1 °C | |
| Temperature Accuracy: $\pm 0,5$ °C | |
| Operating Temperature: 0÷100 °C | |
| Max operating Pressure: 11bar | |
| Minimum operating conductivity: 50 μ S/cm | |
| Protocol Type: Modbus RTU | |
| Cable length: 10m integrated with the sensor | |
| Current Absorption: <1W | |
| Power Supply: 24Vdc | |
| Dimensions (LxHxP): 27x213x27mm | |

Order code

| | |
|------------|---|
| 9701010097 | S401DIG/N Digital pH Electrode cable10m |
|------------|---|